



EXPLORE THE CARNEGIE MANSION



Welcome to Cooper Hewitt, Smithsonian Design Museum!

Our museum is in the former home of Andrew Carnegie and his family. Andrew Carnegie found success in the steel business during the late 1800s when railroads were being built.

The mansion was completed in 1902 and was designed with the latest technology: five elevators, central heating, and a coal car in the cellar on a miniature train track!

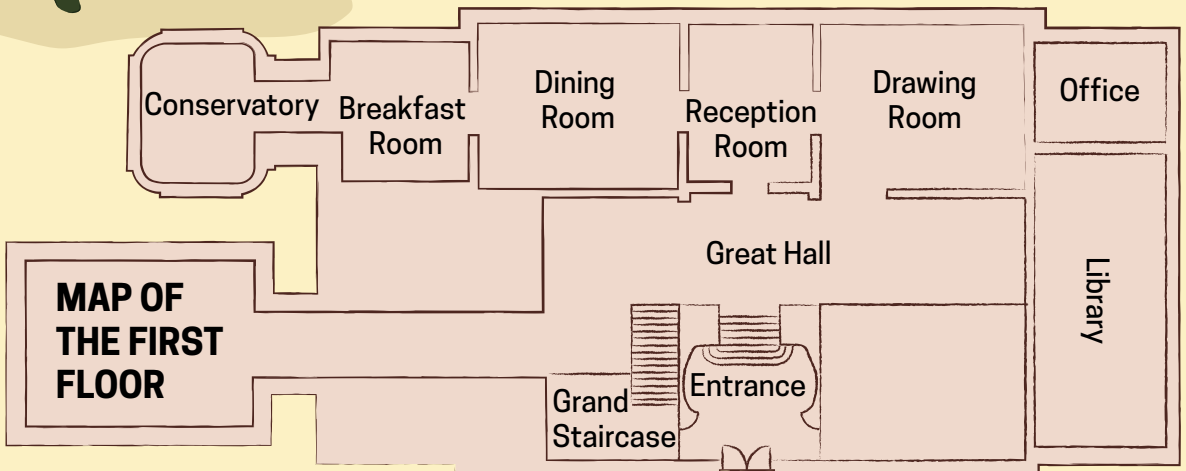

MANSION SCAVENGER HUNT

FIND these items on the first floor. Check off an item once it's found.

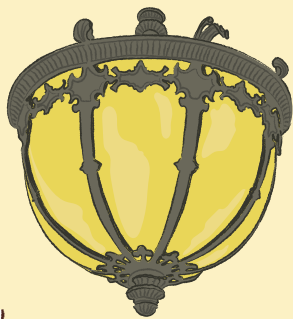

Caldwell lighting

Hint: Look at the ceiling in the Great Hall.



Gold floral canvas

Hint: Look towards the top of the walls in the Great Hall.



Wave pattern

Hint: Look at the walls along the Grand Staircase.



Wooden acorns

Hint: Look closely at the railing of the Grand Staircase.



Golden instrument

Hint: Look at the four upper corners of the Drawing Room.

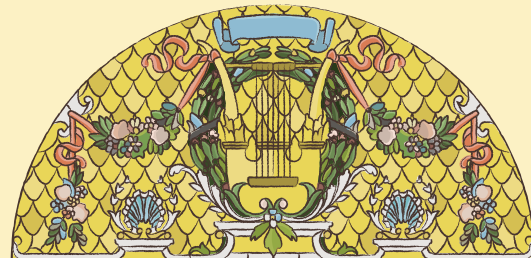

Tiffany window

Hint: Look up high in the Reception Room.

On the first floor of the mansion, look around you to find different shapes and patterns.

DRAW a geometric pattern.



DRAW a pattern inspired by nature.

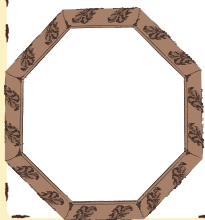
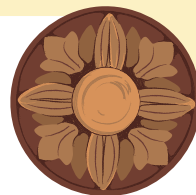

WRITE your name on the tablecloth. The Carnegies would have grand feasts in the Dining Room and would embroider each guest's signature onto the tablecloth.



M. Curie

COOPER HEWITT

 Smithsonian Design Museum

ASK someone at the visitor desk the questions below.
Write their answers in the blank spaces.



DRAW flowers that you would grow in the garden. Some of the original plants are still there such as wisteria (climbing up the building), **geraniums**, and **azaleas**.

